

BSPP, ISO 228-1

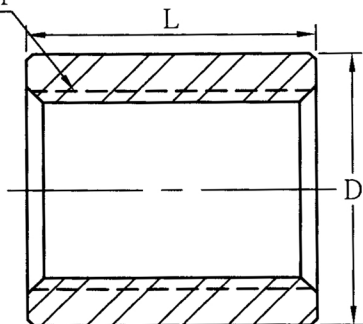

SIZE	PRODUCT CODE	DIMENSIONS		KG EACH
		D	L	
1/8	3S02P	16	19	0.02
1/4	3S04P	19	27	0.03
3/8	3S06P	22	29	0.04
1/2	3S08P	28	33	0.09
3/4	3S12P	35	40	0.20
1	3S16P	44	46	0.28
1-1/4	3S20P	57	51	0.51
1-1/2	3S24P	64	51	0.60
2	3S32P	76	60	1.10
2-1/2	3S40P	92	70	1.32
3	3S48P	108	77	1.96

**\*\* DIMENSIONS SUBJECT TO CHANGE - PLEASE CONTACT US IF CRITICAL \*\***

NERO's range of Full Couplings are available in BSPT, BSPP, NPT and Socket Weld configurations - ASME B16.11-2016

Pressure rating up to 200 BAR (3000 PSI)

Full Material traceability is available and 3.1B certification can be provided upon request

BSPP threads are to ISO 228-1

Larger sizes are available upon request

Couplings can also be supplied as part of our low pressure 150lb range

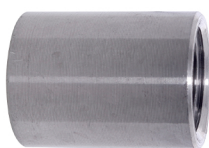

**We also keep Full Couplings in Socket Weld 3000lb 316/L**



5 STAR ★★★★★  
CUSTOMER SERVICE



SAME DAY DISPATCH -  
ORDERS PLACED BEFORE 4:30PM



WEALTH OF  
INDUSTRY KNOWLEDGE



ONE OF THE LARGEST  
STOCKISTS IN THE UK

CALL: +44 (0)121 665 3900 EMAIL: [INFO@NERO.CO.UK](mailto:info@nero.co.uk)

UNIT 2, UNION RD, ANGLO AFRICAN INDUSTRIAL ESTATE, OLDBURY, WEST MIDLANDS B69 3EX

[WWW.NERO.CO.UK](http://WWW.NERO.CO.UK)