

CODE	ΦD (MM)	G (BSPP)	A	E	B	ΦP	H	WEIGHT (G)
PI-4MMSE2BSPP	4	G1/8	5	16.9	18.9	9	12	19
PI-4MMSE4BSPP		G1/4	6.5		21.4		17	24
PI-6MMSE2BSPP	6	G1/8	5	21.1	19	11	14	23
PI-6MMSE4BSPP		G1/4	6.5		21.5		17	28
PI-6MMSE6BSPP		G3/8	6.5		22		19	41
PI-8MMSE2BSPP	8	G1/8	5	22	22	13.7	14	29
PI-8MMSE4BSPP		G1/4	6.5		24.4		17	32
PI-8MMSE6BSPP		G3/8	6.5		24.9		19	38
PI-10MMSE4BSPP	10	G1/4	6.5	24.6	25.5	15.5	19	44
PI-10MMSE6BSPP		G3/8	6.5		26		24	51
PI-10MMSE8BSPP		G1/2	9		28.5		24	61
PI-12MMSE4BSPP	12	G1/4	6.5	28.8	27.5	18.7	19	56
PI-12MMSE6BSPP		G3/8	6.5		28		19	64
PI-12MMSE8BSPP		G1/2	9		30.5		24	71

**** DIMENSIONS SUBJECT TO CHANGE - PLEASE CONTACT US IF CRITICAL ****

FEATURES

- Fast Connection
- High Temperature up to 150°C
- Small, compact design
- Good resistance to chemical corrosive environments
- Food safety
- Allow full flow through Hose / Tubing

MATERIAL CONSTRUCTION

- Metal Body - SS 316
- Push Button - SS 316
- Claws - SS301
- Seals - FKM

SPECIFICATIONS

- Operating Pressure - 0-20 BAR
- Operating Temperature - -20 to 150°C
- Vacuum Rating - To 28" Hg
- Application - Air, Vacuum, Steam Beverage, Oil
- Types - Elbow

FITTINGS ADVANTAGE

- Easy to push in and pull out tubes
- Raw material is SS316L and seal is FKM, for high temp and corrosive environments
- 100% tested, no leakage



SSPL-G

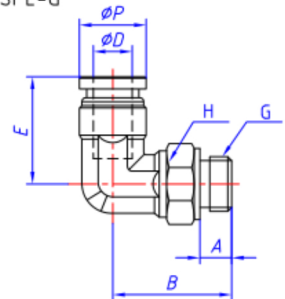

We also stock a range of Push-In fittings to work alongside these fittings



Applications:

- Pneumatics
- Air brake, fuel and lube applications
- Production lines (industrial and automotive)



5 STAR ★★★★★
CUSTOMER SERVICE



SAME DAY DISPATCH -
ORDERS PLACED BEFORE 4:30PM



WEALTH OF
INDUSTRY KNOWLEDGE



ONE OF THE LARGEST
STOCKISTS IN THE UK

CALL: +44 (0)121 665 3900 EMAIL: INFO@NERO.CO.UK

UNIT 2, UNION RD, ANGLO AFRICAN INDUSTRIAL ESTATE, OLDBURY, WEST MIDLANDS B69 3EX

WWW.NERO.CO.UK