

BSPP, ISO 228-1

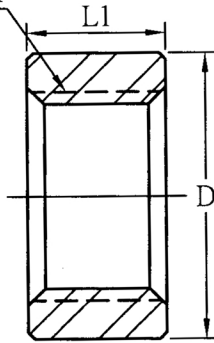

SIZE	PRODUCT CODE	DIMENSIONS		KG EACH
		D	L1	
1/8	3HS02P	16	10	0.02
1/4	3HS04P	19	13	0.03
3/8	3HS06P	22	15	0.03
1/2	3HS08P	28	16	0.06
3/4	3HS12P	35	18	0.11
1	3HS16P	44	21	0.23
1-1/4	3HS20P	57	24	0.37
1-1/2	3HS24P	64	24	0.54
2	3HS32P	76	27	0.70
2-1/2	3HS40P	92	32	1.13
3	3HS48P	108	38	1.68

** DIMENSIONS SUBJECT TO CHANGE - PLEASE CONTACT US IF CRITICAL **

NERO's range of Half Couplings are available in BSPT, BSPP, NPT and Socket Weld configurations - ASME B16.11-2016

Pressure rating up to 200 BAR (3000 PSI)

Full Material traceability is available and 3.1B certification can be provided upon request

BSPP threads are to ISO 228-1

Larger sizes are available upon request

Couplings can also be supplied as part of our low pressure 150lb range



We also keep Half Couplings in Socket Weld 3000lb 316/L



5 STAR ★★★★★
CUSTOMER SERVICE



SAME DAY DISPATCH -
ORDERS PLACED BEFORE 4:30PM



WEALTH OF
INDUSTRY KNOWLEDGE



ONE OF THE LARGEST
STOCKISTS IN THE UK